

Gas Actuated Thermometers Stainless Steel Series Model 73

WIKA Data Sheet TM 73.01

Applications

- Suitable for corrosive media in the chemical, petrochemical and process engineering industries
- Universally suitable for plant, machinery, tank, apparatus construction and food industry
- Temperature measurement without any contact to the medium
- Mounting in instrument boards, control cabinets, control panels

Special Features

- Instruments meet the highest standards of measurement technology
- Case and stem material stainless steel
- For external mounting on pipes and tanks
- Various designs of connection and case mounting
- Also versions with adjustable stem and dial, with capillary, with surface-mounted contact bulb or in panel mounting design (square)

Description

This series of thermometers is universally suitable for the machinery, plant and apparatus construction. Gas actuated thermometers with capillary are used in locations which are not easily accessible and where long distances have to be bridged.

The stem, the process connection and the case of the instrument ¹⁾ are made from stainless steel. Various insertion lengths and process connections are available to optimally match the requirements of each process. The thermometers have a high ingress protection of IP 65 and can be used in outdoor applications even at minus temperatures. With liquid damping they are suitable for use under high-vibration conditions.



Fig. left: Gas Actuated Thermometer Model R73.100
Fig. centre: with Capillary and Surface Mounting Bracket Model F73.100
Fig. right: Adjustable Stem and Dial Model S73.100

Due to the wide variety of possible designs the Model 73 gas actuated thermometers can be perfectly adapted to any process connection and location. For instance the adjustable stem and dial version can be adjusted to almost any angle to allow easy reading, and with the version with surface-mounted contact bulb temperature measurements are possible without any contact to the medium, even when the pipe diameter is extremely small. The contact bulb is intended for external mounting on pipes and tanks. When mounting this thermometer version, it has to be ensured that the contact bulb is in contact with the measuring point over its complete length.

1) Not with Model Q73.144, panel mounting case galvanised steel

Standard features

Temperature element

Inert gas expansion system (non-toxic)

Nominal size

100, 160, 144 x 144

Design of connection

- S Standard (male thread connection)
- 1 Plain stem
- 2 Male nut
- 3 Union nut
- 4 Compression fitting (sliding on stem)
- 5 Union nut with fitting
- 6 Compression fitting (sliding on capillary)

Location of stem

- A73.XXX centre back (axial)
- R73.XXX bottom (radial)
- S73.XXX centre back, adjustable stem and dial
- F73.XXX with capillary
- Q73.144 panel mounting series

Accuracy class

Class 1 per DIN EN 13 190

Working range

Normal: measuring range per DIN EN 13 190
Short time (24 h max.): scale range per DIN EN 13 190

Nominal use

EN 13 190

Case, bezel ring, stem, process connection

Stainless steel

Adjustable Stem and Dial

Stainless steel
Rotatable on stem 360°
Stem adjustable every angle

Panel mounting case and panel frame

Galvanised steel

Surface-mounted contact bulb

120 x 22 x 12 mm, stainless steel 1.4571

Capillary

2 mm diameter, stainless steel 1.4571, bending radius no less than 6 mm
length to user specifications

Dial

White aluminium with black lettering

Window

Laminated safety glass
(panel mounting series: non-splintering plastic)

Pointer

Adjustable black aluminium pointer

Temperature limits for storage and transport

- 50 °C ... +70 °C (EN 13 190) without liquid damping
- 20 °C ... +60 °C (EN 13 190) with food-compatible liquid damping
- 50 °C ... +60 °C (EN 13 190) with liquid damping

Ambient temperature limit at the case

0 °C ... +40 °C max. (others on request)

Pressure rating of stem

25 bar max., static

Ingress protection

IP 65 (EN 60 529 / IEC 529)
Exception with Model Q73.144: IP 65 at the front
IP 40 at the back

Design of case mounting with F73.XXX

- Surface mounting flange, stainless steel
- Surface mounting bracket, die cast aluminium
- Panel mounting flange, stainless steel
- Triangular bezel with bracket, stainless steel

Optional extras

- Scale range °F, °C/°F (dual scale)
- Case with liquid damping
- Case with food-compatible liquid damping
- Armoured or coated capillary: armoured capillary Ø 7 mm, flexible or capillary with PVC coating
- Stem diameter 6, 8, 10, 12 mm (others on request)
- Alarm contacts (see data sheet AC 08.01)
- Ingress protection IP 66 (not for gauges with alarm contacts)

Scale, measuring ranges¹⁾, limits of error per EN 13 190

Scale graduation according to WIKA standard

Scale range in °C	Measuring range in °C	Scale spacing in °C	Limit of error ± °C
-80 ... +60	-60 ... +40	2	2
-60 ... +40	-50 ... +30	1	1
-40 ... +60	-30 ... +50	1	1
-30 ... +50	-20 ... +40	1	1
-20 ... +60	-10 ... +50	1	1
-20 ... +80	-10 ... +70	1	1
0 ... 60	+10 ... +50	1	1
0 ... 80	+10 ... +70	1	1
0 ... 100	+10 ... +90	1	1
0 ... 120	+20 ... +140	2	2
0 ... 160	+20 ... +140	2	2
0 ... 200	+20 ... +180	2	2
0 ... 250	+30 ... +220	5	2.5
0 ... 300	+30 ... +270	5	5
0 ... 400	+50 ... +350	5	5
0 ... 500	+50 ... +450	5	5
0 ... 600	+100 ... +500	10	10
0 ... 700	+100 ... +600	10	10

¹⁾ The measuring range is indicated on the dial by two triangular marks.
Only within this range the stated limit of error is valid according to DIN EN 13 190.

Models

Model	NS	Location of stem
A73.100	100	centre back
A73.160	160	centre back
R73.100	100	radial bottom
R73.160	160	radial bottom
S73.100	100	adjustable stem and dial
S73.160	160	adjustable stem and dial
F73.100	100	with capillary
F73.160	160	with capillary
Q73.144	144	panel mounting series

Dimensions in mm

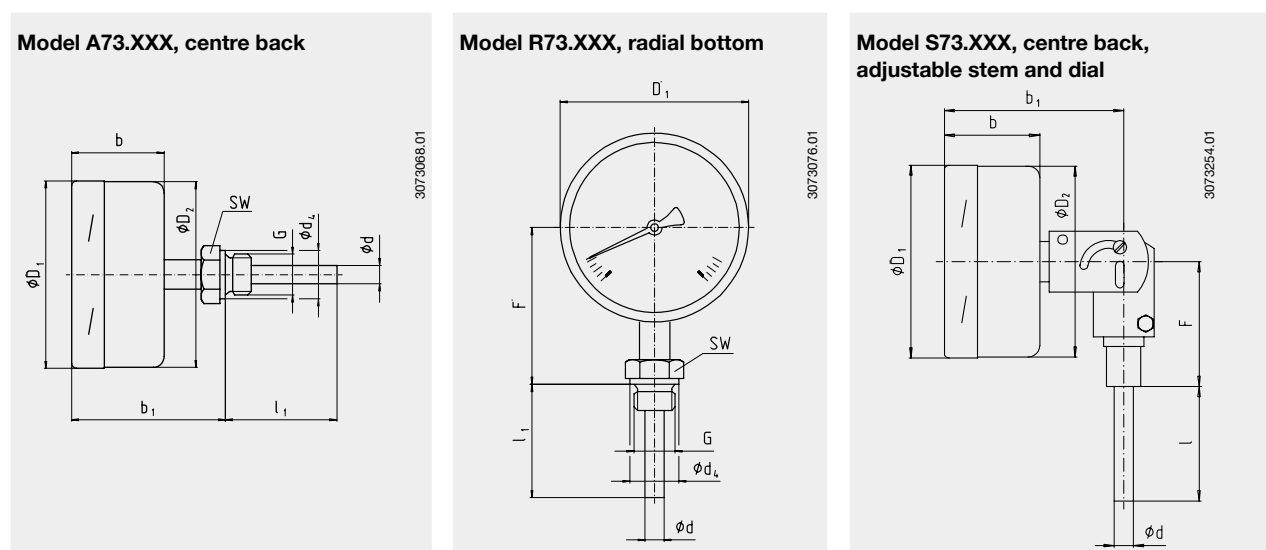

Table of dimensions for Model A73.XXX and R73.XXX

Nom. size	Dimensions in mm													Weight in kg
	Alarm contacts of Model 811, 821 or 831													
NS	without		single or double		triple		d	d ₄	D ₁	D ₂	F ¹⁾	G	SW	
	b	b ₁ ¹⁾	b	b ₁ ¹⁾	b	b ₁ ¹⁾								
100	50	83	88	121	-	-	8 ²⁾	26	101	99	83	G ½ B	27	1.1
160	50	83	88	121	96	129	8 ²⁾	26	161	159	113	G ½ B	27	1.4

1) With scale ranges $\geq 0 \dots 500$ °C the dimensions increase by 40 mm

2) Optional: stem diameter 6, 10, 12 mm

Table of dimensions for Model S73.XXX

Nom. size	Dimensions in mm										Weight in kg
	Alarm contacts of Model 811, 821 or 831										
NS	without		single or double		triple		d	D ₁	D ₂	F	
	b	b ₁	b	b ₁	b	b ₁					
100	50	93	88	131	-	-	8 ¹⁾	101	99	68	1.3
160	50	93	88	131	97	140	8 ¹⁾	161	159	68	1.6

1) Optional: stem diameter 6, 10, 12 mm

Model F73.XXX, with capillary and 3-hole surface mounting flange

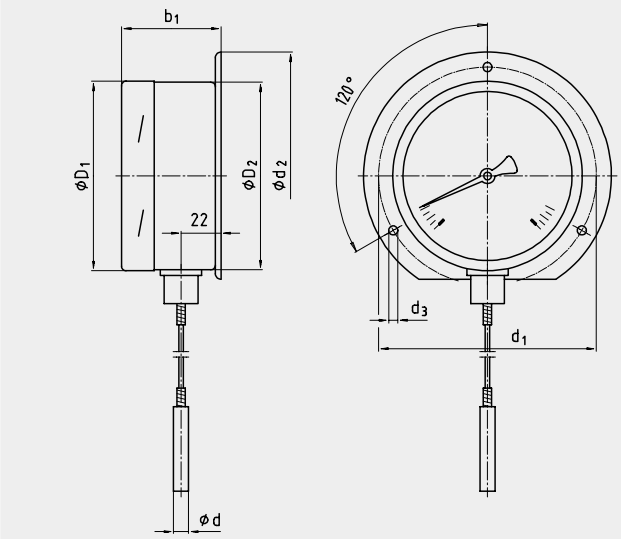

3073165.02

Model F73.XXX, with capillary and surface mounting bracket

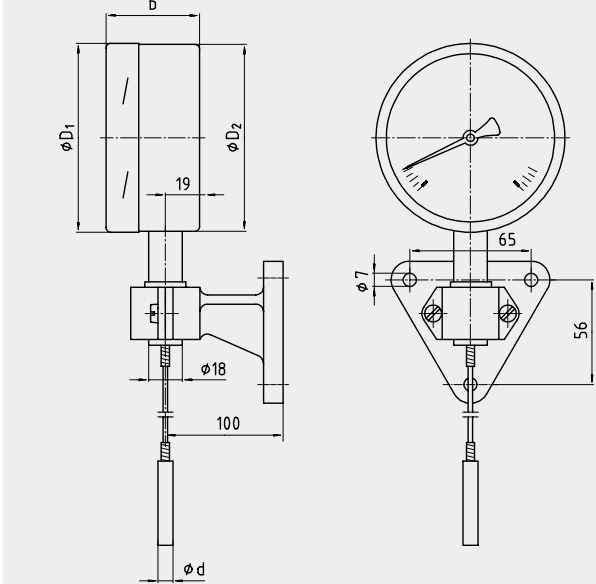

3073270.01

Model F73.XXX, with capillary and 3-hole panel mounting flange

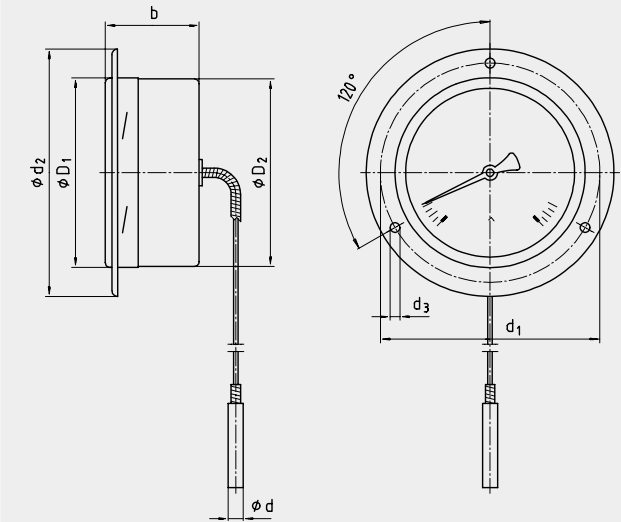

3073289.02

Model F73.XXX, with capillary and triangular bezel with bracket 1)

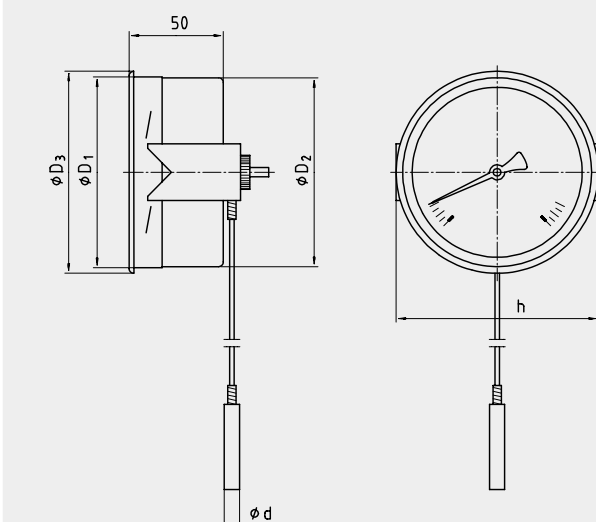

3073297.02

1) Not suitable for alarm contacts

Table of dimensions for Model F73.XXX (with capillary)

Nom. size	Dimensions in mm														Weight in kg
	Alarm contacts of Model 811, 821 or 831														
	without		single or double		triple		d	d ₁	d ₂	d ₃	D ₁	D ₂	D ₃	h	
b	b ₁	b	b ₁	b	b ₁										
100	50	53	88	91	-	-	8 1)	116	132	4.8	101	99	107	107	1.4
160	50	53	88	91	97	100	8 1)	178	196	5.8	161	159	166	172	1.8

1) Optional: stem diameter 6, 10, 12 mm

Model A73.XXX, with surface-mounted contact bulb, centre back

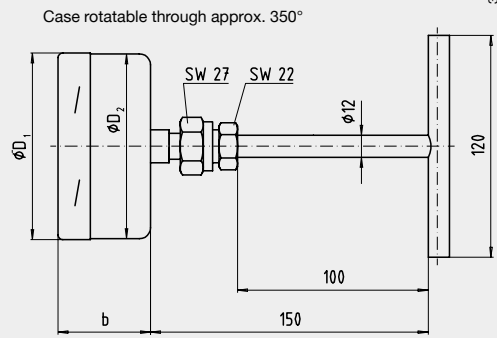

Model R73.XXX, with surface-mounted contact bulb, radial bottom

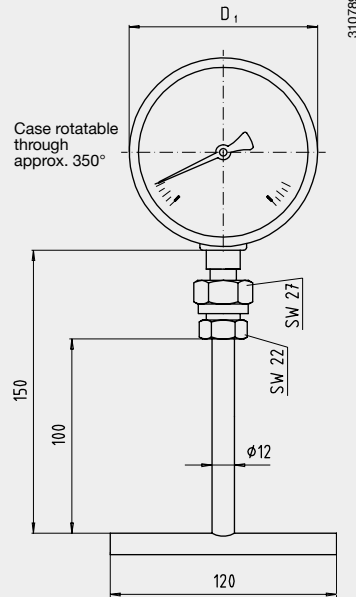

Model S73.XXX, with surface-mounted contact bulb, centre back, adjustable stem and dial

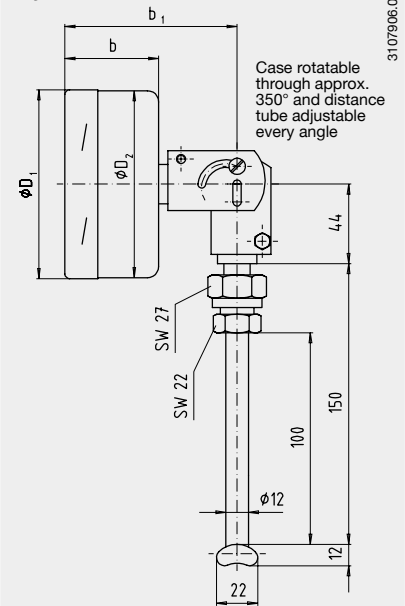
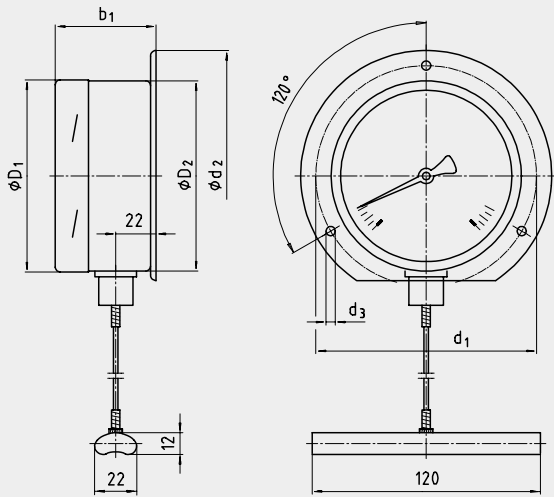

Table of dimensions for Model A73.XXX, R73.XXX and S73.XXX (with surface-mounted contact bulb)

Model	Nominal size	Dimensions in mm						Alarm contacts of Model 811, 821 or 831		Weight in kg
		without		single or double		triple		D ₁	D ₂	
		NS	b	b ₁	b	b ₁	b			
A73.100	100	50	-	88	-	-	-	101	99	0.8
A73.160	160	50	-	88	-	97	-	161	159	0.9
R73.100	100	50	-	88	-	-	-	101	99	0.8
R73.160	160	50	-	88	-	97	-	161	159	0.9
S73.100	100	50	93	88	131	-	-	101	99	0.9
S73.160	160	50	93	88	131	97	140	161	159	1.0

Model F73.XXX, with surface-mounted contact bulb, capillary and 3-hole surface mounting flange

3107949.01



Model F73.XXX, with surface-mounted contact bulb, capillary and surface mounting bracket

3107957.01

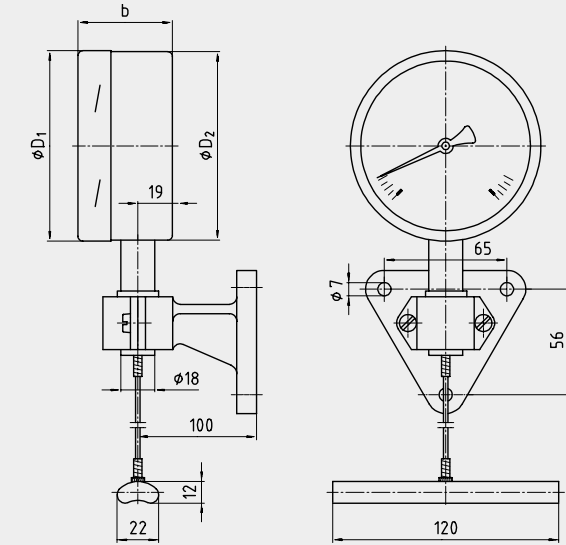

Model F73.XXX, with surface-mounted contact bulb, capillary and 3-hole panel mounting flange

3107965.01

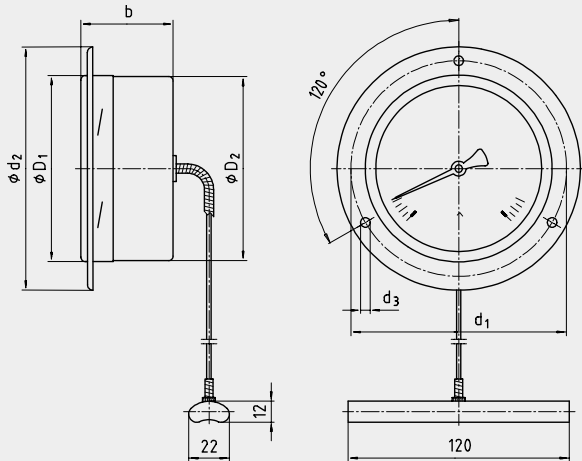

Model F73.XXX, with surface-mounted contact bulb, capillary and triangular bezel with bracket 1)

3107973.01

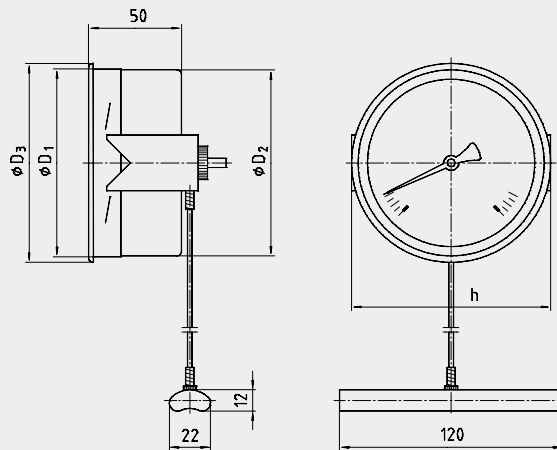

1) Not suitable for alarm contacts

Table of dimensions for Model F73.XXX (with surface-mounted contact bulb and capillary)

Nom. size	Dimensions in mm						d ₁	d ₂	d ₃	D ₁	D ₂	D ₃	h	Weight in kg
	Alarm contacts of Model 811, 821 or 831 without		single or double		triple									
NG	b	b ₁	b	b ₁	b	b ₁								
100	50	53	88	91	-	-	116	132	4.8	101	99	107	107	1.4
160	50	53	88	91	97	100	178	196	5.8	161	159	166	172	1.8

Mounting instructions for surface-mounted contact bulb

General

The contact bulb has been designed for surface mounting on pipes and tanks.

The contact bulb is to be mounted so that it lays over the measuring point down its full length. Basic requirements to ensure perfect measurement results are good thermal contact between the surface-mounted contact bulb and the outside wall of the pipe or tank with minimal heat loss to the ambient from the surface-mounted contact bulb and measuring point.

Mounting on pipes

The geometry of the contact bulb has been designed for pipes with external diameters between 20 and 160 mm. Pipe clips are adequate for fastening the surface-mounted contact bulb to the pipe. The surface-mounted contact bulb should have direct metallic contact with the measuring point and have firm contact with the surface of the pipe. In so far as temperatures under 200 °C are to be expected a heat conductive paste can be used to optimise the heat transmission between surface-mounted contact bulb and pipe.

Lagging must be applied where the surface-mounted contact bulb has been mounted to avoid error due to heat loss. This lagging must have sufficient temperature resistance and is not provided with the instrument.

Mounting on tanks

The geometry of the contact bulb has been designed for tanks with an external radius up to 80 mm. If the mounting point of the surface-mounting contact bulb on the tank has an external radius greater than 80 mm, we recommend the use of an intermediate piece designed for the respective tank diameter made of a material with good thermal conductivity.

The contact bulb should be fastened to the tank by means of an angle bracket with clamping screws, or any similar method.

The surface-mounted contact bulb should have direct metallic contact with the measuring point and have firm contact with the surface of the tank. In so far as temperatures under 200 °C are to be expected a heat conductive paste can be used to optimise the heat transmission between surface-mounted contact bulb and tank. Lagging must be applied where the surface-mounted contact bulb has been mounted to avoid error due to heat loss. This lagging must have sufficient temperature resistance and is not provided with the instrument.

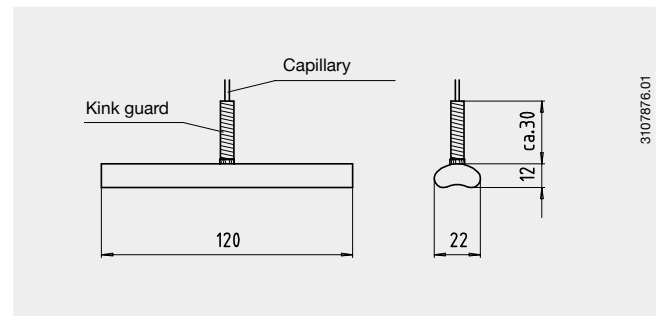

3107876.01

Pipe clip mounting

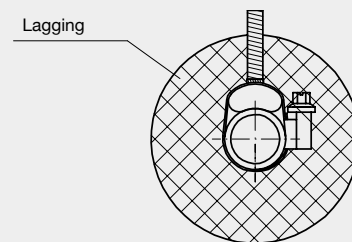

3107922.01

Angle bracket mounting

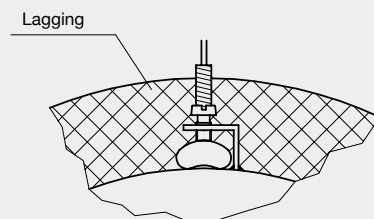

3107930.01

Model Q73.144, panel mounting series

Panel mounting case, 144 x 144 mm, lower back capillary entry

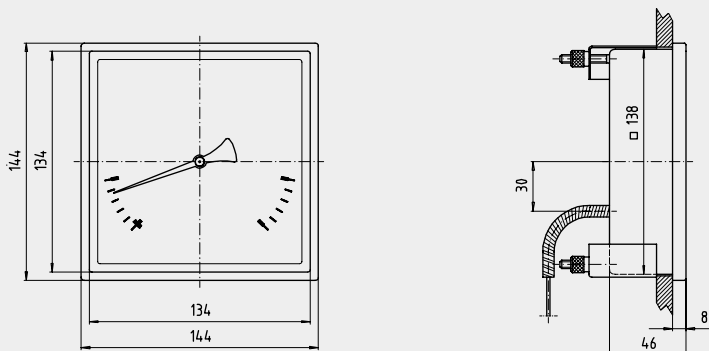

Model Q73.144, panel mounting series with optional alarm contacts

Panel mounting case, 144 x 144 mm, lower back capillary entry

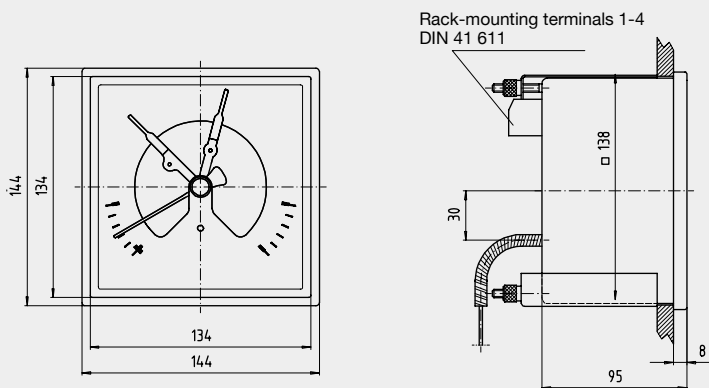

Panel cutout in mm

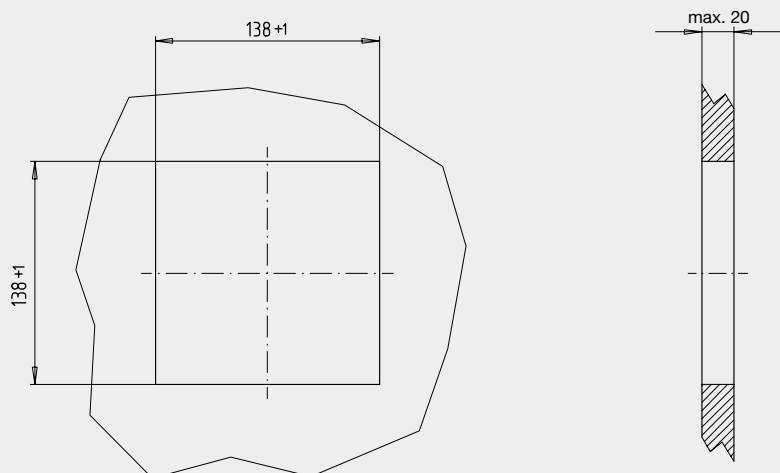

Design of connection

Design S, standard (male thread connection)

Standard stem lengths l_1 : 63, 100, 160, 200, 250 mm
(not with F73.XXX and Q73.144)

Nominal size NS	Process connection		Dimensions in mm		
	G	i	SW	d_4	$\varnothing d$
100, 160	G 1/2 B	14	27	26	6; 8; 10; 12
	G 3/4 B	16	32	32	6; 8; 10; 12
	1/2 NPT	19	22	-	6; 8; 10; 12
	3/4 NPT	20	30	-	6; 8; 10; 12

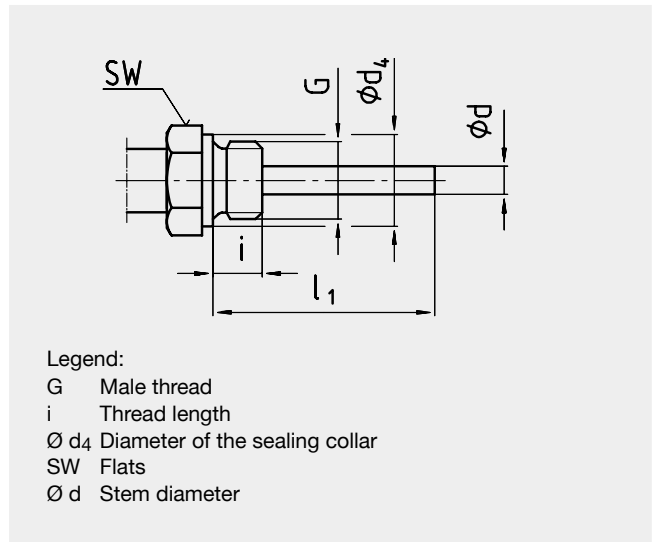

Design 1, plain stem

Standard stem lengths l : 100, 140, 200, 240, 290 mm
Basis for design 4, compression fitting

Nominal size NS	Dimensions in mm	
	d_6 1)	$\varnothing d$
100, 160, 144 x 144	18	6; 8; 10; 12

1) Not applicable to version with capillary

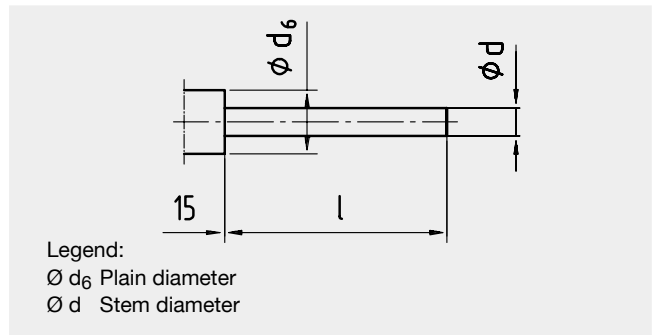

Design 2, male nut

Standard stem lengths l_1 : 80, 140, 180, 230 mm

Nominal size NS	Process connection		Dimensions in mm		
	G	i	SW	$\varnothing d$	
100, 160, 144 x 144	G 1/2 B	20	27	6; 8; 10; 12	
	M20 x 1.5	15	22	6; 8; 10; 12	

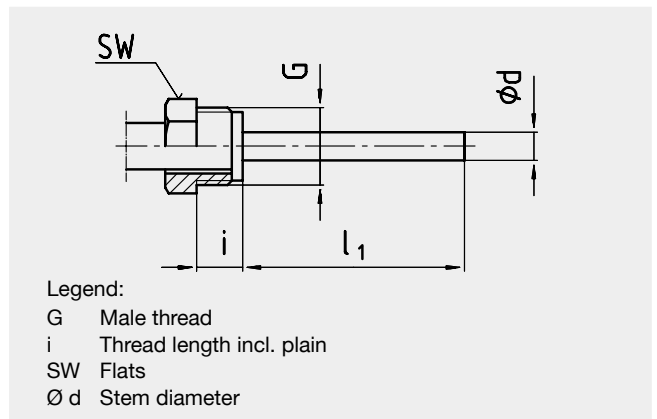

Design 3, union nut

Standard stem lengths l_1 : 89, 126, 186, 226, 276 mm

Nominal size NS	Process connection		Dimensions in mm		
	G	i	SW	$\varnothing d$	
100, 160, 144 x 144	G 1/2	8.5	27	6; 8; 10; 12	
	G 3/4	10.5	32	6; 8; 10; 12	
	M24 x 1.5	13.5	32	6; 8; 10; 12	

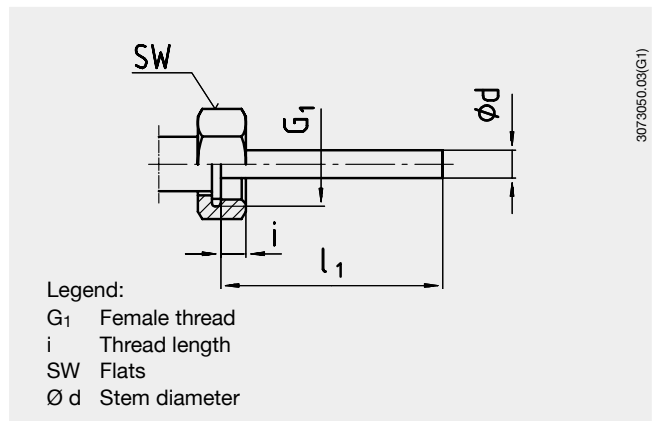

Design 4, compression fitting (sliding on stem)

Length of stem l_1 = variable

Length $L = l_1 + 40$ mm

Nominal size NS	Process connection			Dimensions in mm		
	G	i	SW	d_4	$\varnothing d$	
100, 160, 144 x 144	G 1/2 B	14	27	26	6; 8; 10; 12	
	G 3/4 B	16	32	32	6; 8; 10; 12	
	1/2 NPT	19	22	-	6; 8; 10; 12	
	3/4 NPT	20	30	-	6; 8; 10; 12	

Design 5, union nut G 1/2 with fitting

Standard stem lengths l_1 : 63, 100, 160, 200, 250 mm

Nominal size NS	Process connection			Dimensions in mm		
	G	i	SW	d_4	$\varnothing d$	
100, 160, 144 x 144	G 1/2 B	14	27	26	6; 8; 10; 12	
	G 3/4 B	16	32	32	6; 8; 10; 12	
	1/2 NPT	19	22	-	6; 8; 10; 12	
	3/4 NPT	20	30	-	6; 8; 10; 12	

Optional: Union nut M24 x 1.5 with fitting M18 x 1.5

Nominal size NS	Process connection			Dimensions in mm		
	G	i	SW	d_4	$\varnothing d$	
100, 160	M18 x 1.5	12	32	23	6; 8; 10	

Design 6, compression fitting (sliding on capillary)

Standard stem lengths l : 100 mm (others on request)

Nominal size NS	Process connection			Dimensions in mm		
	G	i	SW	d_4	$\varnothing d$	
100, 160, 144 x 144	G 1/2 B	14	27	26	6; 8; 10; 12	
	G 3/4 B	16	32	32	6; 8; 10; 12	
	1/2 NPT	19	22	-	6; 8; 10; 12	
	3/4 NPT	20	30	-	6; 8; 10; 12	

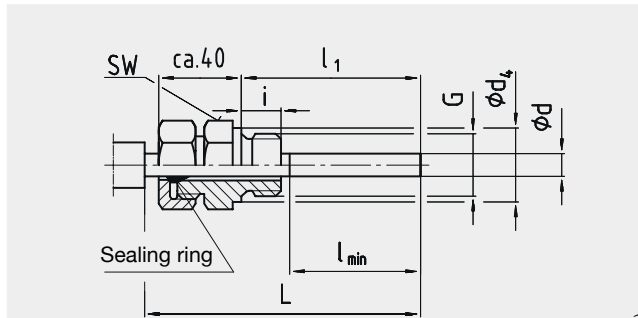

3073050.03(G2)

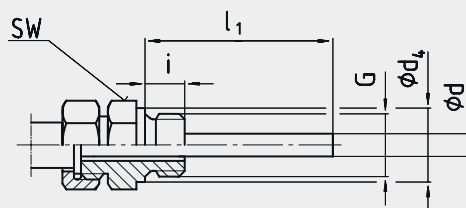

Legend:

- G Male thread
- i Thread length
- $\varnothing d_4$ Diameter of the sealing collar
- SW Flats
- $\varnothing d$ Stem diameter

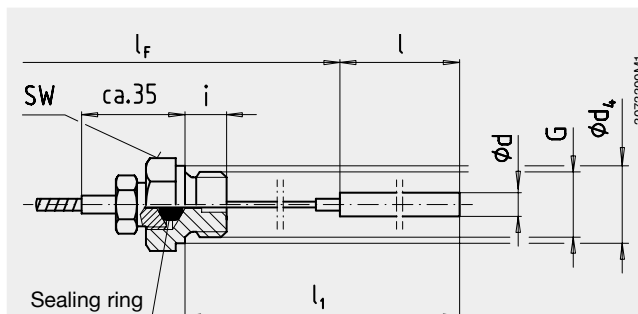

3073300M1

Legende:

- G Male thread
- i Thread length
- $\varnothing d_4$ Diameter of the sealing collar
- l_F Length of capillary
- SW Flats
- $\varnothing d$ Stem diameter

Ordering information

Model / Nominal size / Scale range / Design and size of connection / Length of stem l , l_1 / Length of capillary l_F / Optional extras required

Modifications may take place and materials specified may be replaced by others without prior notice. Specifications and dimensions given in this leaflet represent the state of engineering at the time of printing.



WIKAL Alexander Wiegand GmbH & Co. KG
 Alexander-Wiegand-Straße 30
 63911 Klingenberg/Germany
 Phone (+49) 93 72/132-0
 Fax (+49) 93 72/132-406
 E-Mail info@wika.de
 www.wika.de